

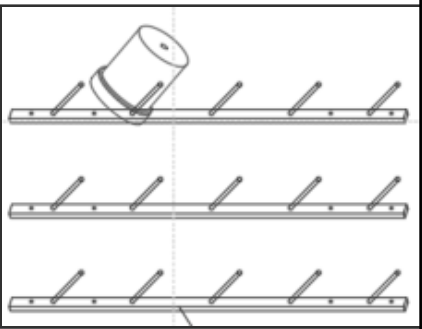

2' X 2' LED LIGHT  
FIXTURE BY LITHONIA,  
SEE SHEET A1.0

BUCKET HANGING  
RACKS PROVIDED BY  
OWNER, INSTALLED BY  
CONTRACTOR



K1



K2

FOOD PREP ROOM EQUIPMENT SPECIFICATIONS ON FOLLOWING PAGES. FOR MORE INFORMATION, SEE ALSO SPECIFICATIONS ON DRAWINGS, SHEET 1.0

K1 - 48" Worktop Refrigerator, Avantco AU-48R-HC or similar.

K2 - 72" Stainless Steel Open Wall Cabinet, Regency Space Solutions, 72" Stainless Steel Open Wall Cabinet or similar.

K3 - Stainless Steel Food Prep Table with Double Sink. 14 gauge type 304 stainless steel top with Gooseneck faucet, stainless steel drawer, stainless steel legs and adjustable bullet feet.

Bucket hanging racks (3) provided by owner, installed by contractor

ADD GOOSENECK  
FAUCET WITH  
SEPARATE SPRAY  
NOZZLE

3/4 HP FOOD WASTE  
DISPOSER,  
INSINKERATOR BADGER  
MODEL 900-2, 120V, 9.5  
AMP, 1 PHASE, OR  
EQUAL.

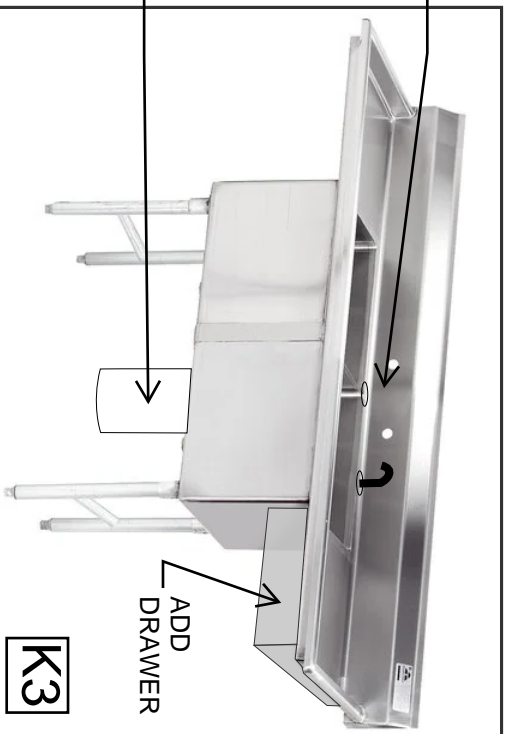

ADD  
DRAWER

K3

## Avantco AU-48R-HC 48" Undercounter Refrigerator

Item #178AU48RHC



### Technical Data

Width	47 1/4 Inches
Depth	29 1/2 Inches
Height	35 1/4 Inches
Power Cord Length	84 Inches
Interior Width	42 5/8 Inches
Left Door Opening Width	19 3/16 Inches
Right Door Opening Width	19 3/16 Inches
Interior Depth	19 13/16 Inches
Interior Height	23 1/2 Inches
Work Surface Height	35 1/4 Inches

### Features

- Corrosion-resistant stainless steel exterior and aluminum interior with 304 stainless steel floor
- Compact, undercounter size takes up minimal space
- Easy-to-read digital temperature controller and auto-defrost function
- Self-closing and stay-open door features for easy loading and unloading of product
- 115V; 1/3 hp; R-290 refrigerant; 1.33 Amps

### Certifications



ETL, US



5-15P



ETL Sanitation

## Technical Data

Amps	1.33 Amps
Voltage	115 Volts
Access Type	Doors
BTU (LBP)	881 BTU
Capacity	11.9 cu. ft.
Construction	Stainless Steel and Aluminum
Features	Removable Magnetic Door Gaskets
Horsepower	1/3 HP
Individual Shelf Capacity	88 lb.
Number of Doors	2 Doors
Number of Shelves	2 Shelves
Plug Type	NEMA 5-15P
Refrigerant Capacity	3.5 oz.
Refrigerant Type	R-290
Sections	2 Sections
Style	Counter Height
Temperature Range	33 - 40 Degrees F
Top Capacity	441 lb.
Type	Refrigerators Undercounter Refrigerators

## Plan View

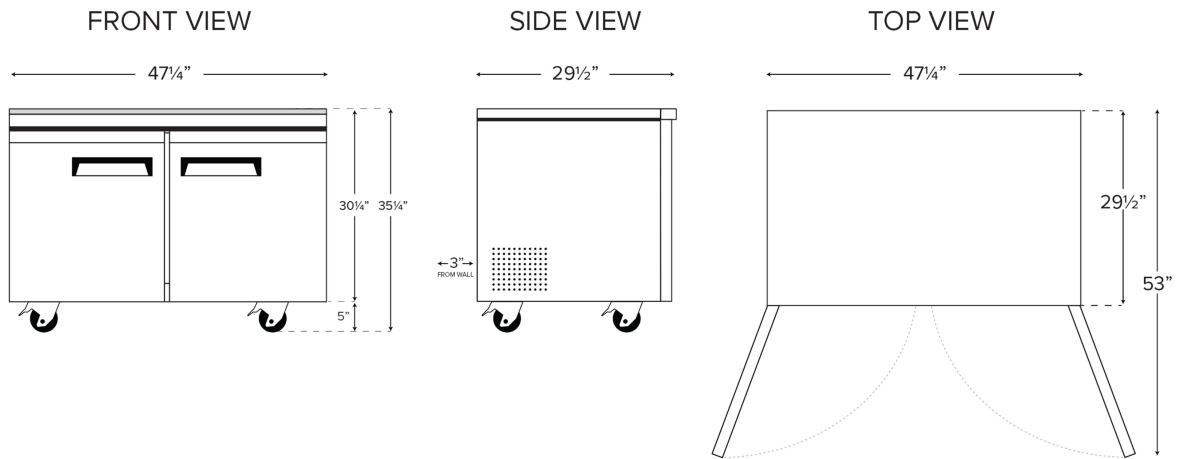



## Notes & Details

The Avantco AU-48R-HC 48" undercounter refrigerator will provide you with a dependable cold food storage solution. With a spacious refrigerator portion readily accessible through its two doors, the unit opens up to two shelves that will aid in organizing your ingredients. Plus, because they each accommodate up to 88 lb., the epoxy-coated steel shelves are well-equipped for holding heavy bulk ingredients, from dozens of eggs to jars of condiments and sauces.

This unit is designed for outstanding durability to ensure that it withstands busy kitchen environments with ease. It features a stainless steel exterior, which provides both strength and a smooth, sleek appearance. The painted aluminum interior with a 304 stainless steel floor also offers the stability necessary for heavy, regular use. Because of its undercounter design, the refrigerator effortlessly adds cold storage space beneath a pre-existing countertop and doesn't require additional space for its own footprint.

This unit ensures optimal performance by operating with a 1/3 hp refrigeration system that circulates R290 refrigerant to maintain temperatures from 33 to 40 degrees Fahrenheit. R290 refrigerant has an ozone depletion potential (ODP) of 0 and a global warming potential (GWP) of 3. The foamed-in-place polyurethane insulation helps provide structural rigidity and maintain internal temperatures.

Operation of the refrigerator is easy, thanks to its special features. Monitor temperatures by consulting the interior wall-mounted thermometer and use the auto-defrost feature on the pre-programmed digital controller to keep the unit in excellent shape. Take advantage of the included casters and roll the unit aside to thoroughly clean the area. This undercounter refrigerator requires a 115V electrical connection for operation.

**⚠ WARNING:** This product can expose you to chemicals including lead, which are known to the State of California to cause cancer, birth defects, or other reproductive harm. For more information, go to [www.p65warnings.ca.gov](http://www.p65warnings.ca.gov).



## Regency 72" Stainless Steel Open Wall Cabinet

#600WCO1572



### Technical Data

Length	72 Inches
Width	15 Inches
Height	32 Inches
Height Between Shelves	10 1/2 Inches
Door Style	None
Door Type	Open
Features	NSF Listed
Gauge	18 Gauge
Installation Type	Wall Mounted
Material	Stainless Steel

### Features

- Durable, corrosion-resistant 18 gauge type 304 stainless steel construction
- (2) 36" flush-mounted cabinets, open cabinets for easy access
- Fixed mid-shelf maximizes storage capacity
- Sloped top makes cleaning easier

### Certifications



## Technical Data

Stainless Steel Type	Type 304
Style	Enclosed
Type	Cabinets

## Notes & Details

Storage is a vital commodity in any business, so make use of unused wall space with this Regency 72" stainless steel wall cabinet! This unit turns an open section of your wall into a place to keep commonly used items so that they're near at hand when you need them, and out of the way when you don't. It's a perfect location to keep chemicals and janitorial supplies, or you can use it for general storage needs in restaurants and office buildings. It boasts an open front that makes it easy to see and access your supplies, which is useful if you'll be using the cabinet frequently and don't want to deal with the hassle of opening a door every time. You can store items on the bottom shelf of the cabinet, and it also comes with a fixed mid-shelf.

The cabinet is made from stainless steel to provide superior durability in any setting, and it comes with a sloped top to make cleaning easy and to discourage dust from settling. This cabinet comes with a cleat-style mounting bracket, and all other mounting hardware is sold separately. This item consists of (2) 36" cabinets that are flush-mounted next to each other.

 **WARNING:** This product can expose you to chemicals including lead, which are known to the State of California to cause cancer, birth defects, or other reproductive harm. For more information, go to [www.p65warnings.ca.gov](http://www.p65warnings.ca.gov).



## Regency 86" 16 Gauge Stainless Steel Two Compartment Commercial Sink with Stainless Steel Legs, Cross Bracing, and 2 Drainboards - 24" x 24" x 14" Bowls

#600S224242X



### Technical Data

Length	86 Inches
Width	29 1/2 Inches
Height	43 3/4 Inches
Drainboard Length	18 Inches
Bowl Depth	14 Inches
Backsplash Height	9 Inches
Basket Drain Size	3 1/2 Inches
Bowl Front to Back	24 Inches
Bowl Left to Right	24 Inches
Drain Outlet Size	1 1/2 Inches

### Features

- 16-gauge type 304 stainless steel construction
- Designed with (2) 14" deep bowls and rounded corners for easy cleaning
- Stainless steel legs, sockets, bullet feet, and crossbracing for maximum strength and longevity
- Includes two 18" drainboards and 3 1/2" drain baskets
- Rolled edge contains splashes and overflow

### Certifications



## Technical Data

Faucet Centers	8 Inches
Features	NSF Listed
Gauge	16 Gauge
Leg Construction	Stainless Steel
Material	Stainless Steel
Number of Compartments	2 Compartments
Number of Drainboards	2 Drainboards
Stainless Steel Type	Type 304
Style	2 Drainboards
Type	Straight / Line Sinks

## Plan View

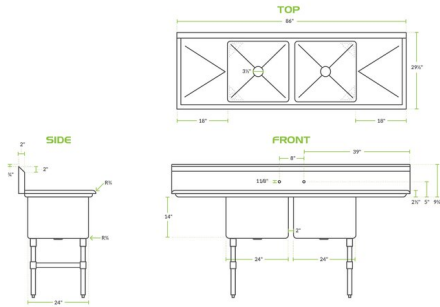

## Notes & Details

Outfit your facility with a long-lasting sink with this Regency 86" stainless steel two compartment sink with 2 drainboards. It's constructed from high-quality, 16-gauge type 304 stainless steel, making it more corrosion-resistant and durable than other sinks made from thinner, 18-gauge type 430 stainless steel. This sink features 2 sturdy, 18" drainboards so you can easily wash and dry dishes and utensils in one convenient location. It's dipped a minimum of 1/4" to facilitate better drainage, and the welded construction contributes to the long-lasting use and overall strength of this sink / drainboard combo.

The 14" deep bowls are die-stamped to a minimum of 1/4" to ensure proper drainage. Plus, each bowl includes a 3 1/2" basket strainer to catch food debris, which prevents the drain from clogging. For easy cleaning, each compartment has rounded corners so you can rinse and wipe down the sink.

A 9" tall backsplash is included and comes complete with (2) 1 1/8" diameter holes punched on 8" centers to accommodate 1 faucet (sold separately). This sink also includes a 1 1/2" raised rolled edge, which is 2" tall on the front and both sides to contain splashes and overflow. The legs are constructed of 1 5/8" diameter stainless steel with stainless steel cross-bracing and adjustable plastic feet for added stability. These features serve to prolong the life of your sink while adding exceptional strength to the unit.

**WARNING:** This product can expose you to chemicals including lead, which are known to the State of California to cause cancer and birth defects or other reproductive harm. For more information, go to [www.p65warnings.ca.gov](http://www.p65warnings.ca.gov).





## Regency 20" x 20" x 5" Drawer with Stainless Steel Front

#600DR2020



### Technical Data

Length	25 1/8 Inches
Width	24 Inches
Height	6 7/8 Inches
Drawer Insert Length	20 Inches
Interior Length	20 Inches
Drawer Insert Width	20 Inches
Interior Width	19 1/2 Inches
Drawer Insert Height	5 Inches
Interior Height	5 Inches
Color	Silver

### Features

- Features a removable insert for easy cleanup
- Smooth operation thanks to ball-bearing slides
- Durable stainless steel and galvanized steel construction
- Easy to install with the included pre-drilled Z brackets; can be stacked up to 2 or 3 drawers high
- Works with 24", 30", and 36" deep Regency tables that are at least 36" long

### Certifications



## Technical Data

Features	NSF Listed
Material	Galvanized Steel Stainless Steel
Number of Drawers	1 Drawers
Stainless Steel Type	Type 304
Type	Drawers

## Plan View

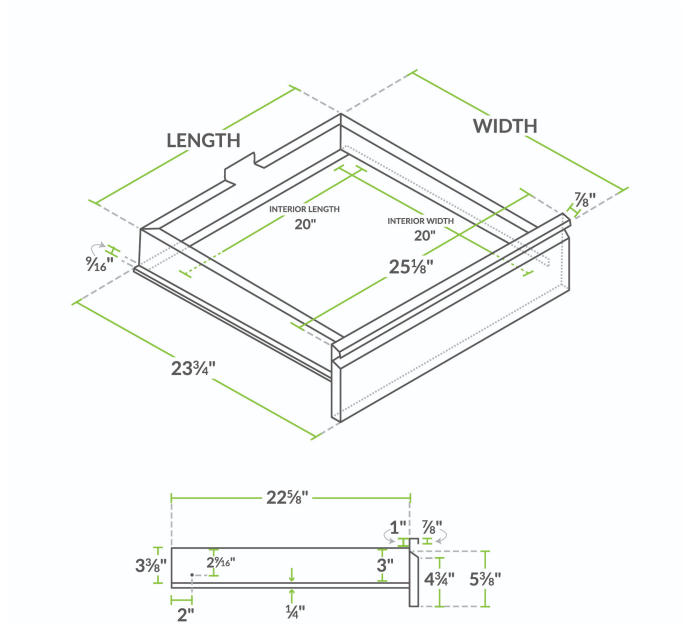

## Notes & Details

Keep your kitchen organized by mounting this Regency Tables and Sinks 20" x 20" x 5" galvanized steel drawer to the hat channels under your work table. Each drawer features an easy-to-clean stainless steel front and moves on ball-bearing sides. The drawer pan is made of 22 gauge, type 304 stainless steel.

Installation is easy thanks to the pre-drilled Z-brackets - simply drill through the table's hat channels and secure the drawer with screws. The drawer can also stack up to 3 high if you need to add more storage down the road - to add a drawer, drill into the bottom of the top drawer's frame, and use screws to mount the lower drawer.

This drawer is compatible with all 24", 30", and 36" deep Regency tables that are at least 36" long. It includes the screws and hex nuts necessary to either mount the Z-brackets to the table, or to attach it to the bottom of another drawer.

**WARNING:** This product can expose you to chemicals including lead, which are known to the State of California to cause cancer and birth defects or other reproductive harm. For more information, go to [www.p65warnings.ca.gov](http://www.p65warnings.ca.gov)

*This Space for Architect/Engineer Approval*

Job Name \_\_\_\_\_ Date \_\_\_\_\_  
 Model Specified \_\_\_\_\_ Quantity \_\_\_\_\_  
 Customer/Wholesaler \_\_\_\_\_  
 Contractor \_\_\_\_\_  
 Architect/Engineer \_\_\_\_\_

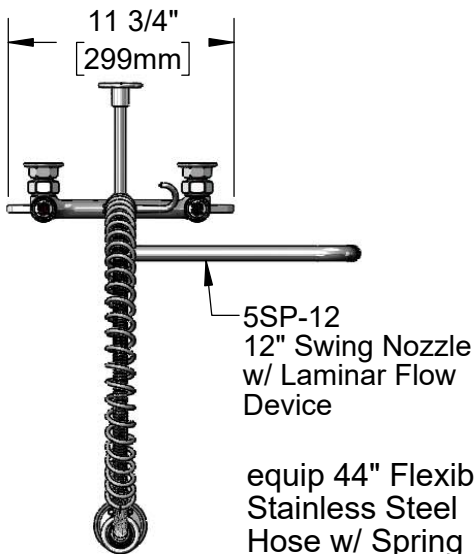

5SP-12  
12" Swing Nozzle  
w/ Laminar Flow  
Device

equip 44" Flexible  
Stainless Steel  
Hose w/ Spring  
& Spray Valve



Items Not Shown  
For Clarity

3/8" NPT x 18"  
Riser

Finger Hook

12 1/8"  
[308mm]

10 3/8"  
[264mm]

7 15/16"  
[202mm]

8"  
[203mm]  
Adjustable From  
7 3/4" to 8 1/4"  
[197mm to 210mm]

Quarter-Turn  
Ceramic Cartridges  
& Lever Handles w/  
Color Coded Screws

5SV  
1.15 GPM  
Spray Valve

2 5/16"  
[59mm]

013716-40  
6" Wall  
Bracket

35 11/16"  
[906mm]

4 7/8"  
[124mm]

4 1/8"  
[105mm]

5AFL12  
Add-On Faucet w/  
Quarter-Turn  
Ceramic Cartridge,  
Lever Handle &  
12" Swing Nozzle

Ø 2" [51mm]  
Flanges w/  
In-Line Check  
Valves & 1/2" NPT  
Female Inlets

Mounting Surface



B-0230-K  
1/2" NPT  
Supply Elbow Kit  
(Sold Separately)

Model Number  
**5PR-8W12**

Product Compliance:  
ASME A112.18.1 / CSA B125.1  
NSF 61 - Section 9  
NSF 372 (Low Lead Content)  
2019 DOE PRSV - Class II

Product Specifications:  
Pre-Rinse Unit: 8" Wall Mount Mixing Faucet, Quarter-Turn Ceramic Cartridges, Lever Handles, Add-On Faucet w/ 12" Swing Nozzle, 44" Flexible Stainless Steel Hose, 1.15 GPM Spray Valve, In-Line Check Valves, 6" Wall Bracket & 1/2" NPT Female Inlets

equip  
Foodservice  
Accessories

by

2 Saddleback Cove, P.O. Box 1088  
Travelers Rest, South Carolina 29690  
Phone: 800.891.4808 Fax: 800.868.0084  
equip.tsbrass.com

Model: WBB3091144

**Lithonia Lighting® 2GTL2 LED Recessed Troffer 24"L x 24"W, LP840, 4000K, 3300 Lumens, Silver**

★★★★★ (0)



Ships in 3 Business Days

**Product Description**

The GTL is a specifiable, general-purpose recessed LED troffer that offers flexibility and control options for budget-constrained spaces. GTL recessed troffer's economical, solid-state lighting is ideal for new construction, renovation and retrofit opportunities. It is ideal for the broad range of applications where general-purpose fluorescent lighting currently prevails including offices, schools and commercial general-ambient applications.

**Specifications**

## Weights & Dimensions

Length	24 in
Width	24 in
Depth	4-1/4

## Product Details

Average Life	72,000 hr
Color Temperature	4000 K
Color	Silver
Series	2GTL2
CRI	80
Voltage	120 - 277 V
Material	Steel
Manufacturers Part Number	237AG5
CI Code	237AG5
Bulb Type	LED
Lumens	3408
Brand	Lithonia Lighting

## Warranty

Warranty	5 Year Limited
----------	----------------

## Compliance & Certifications

Certifications	CSA
----------------	-----

---

# MANUFACTURER'S GUIDE SPECIFICATIONS

---

## **SECTION 07 14 16.11 COLD, FLUID-APPLIED WATERPROOFING**



**SECTION 07 14 16.11****COLD, FLUID-APPLIED WATERPROOFING****PART 1 GENERAL****1.01 SECTION INCLUDES**

- A. Fluid-applied membrane waterproofing and accessory products by Carlisle Coatings & Waterproofing
  
- B. Materials and their installation as indicated on drawings, for primarily-vertical, below-grade, foundation wall surfaces, consisting of [Note to Specifier: incorporate one of these sub-paragraphs into this paragraph]:
  - 1. [Waterproofing only] waterproofing membrane fully-adhered to substrate with overlying protection board from the same manufacturer. Waterproofing membrane provides barrier to water under hydrostatic head, while protection board protects the membrane during backfill.
  - 2. [Waterproofing plus drainage] waterproofing membrane fully-adhered to substrate and overlying drainage composite with perimeter drainage system, all from the same manufacturer. Waterproofing membrane provides barrier to water under hydrostatic head, while drainage materials remove hydrostatic pressure from waterproofing membrane while also serving as a protection course during backfill.
  - 3. [Waterproofing plus insulation] waterproofing membrane fully-adhered to the substrate with overlying board insulation from the same manufacturer. Waterproofing membrane provides barrier to water under hydrostatic head, while board insulation provides R-Value and serves as a protection course during backfill.
  - 4. [Waterproofing plus insulation and drainage] Consists of waterproofing membrane fully-adhered to the substrate plus overlying board insulation and overlying drainage composite and perimeter drainage system, all from the same manufacturer. Waterproofing membrane provides barrier to water under hydrostatic head, while board insulation provides R-Value. Drainage materials remove hydrostatic pressure from waterproofing membrane while also serving as a protection course during backfill

**1.02 RELATED SECTIONS**

- A. Division 03 – Concrete
  
- B. Section 04 20 00 – Unit Masonry
  
- C. Section 07 21 13 Board Insulation

- D. Section 07 90 00 Joint Protection
- E. Division 22 – Plumbing
- F. Division 26 – Electrical
- G. Division 31 - Earthwork
- H. Section [ \_\_\_\_\_ ] Other

1.03 REFERENCES

- A. ASTM C 920 Standard Specification for Elastomeric Joint Sealants
- B. ASTM C 836 Standard Specification for High Solids Content, Cold Liquid-Applied Elastomeric Waterproofing Membrane for use with Separate Wearing Course
- C. ASTM D 412 Standard Test Methods for Vulcanized Rubber and Thermoplastic Elastomers - Tension
- D. ASTM D 903 Standard Test Method for Peel and Stripping Strength of Adhesive Bonds
- E. ASTM D 1970 Standard Specification for Self-Adhering Polymer Modified Bituminous Sheet Materials Used as Steep Roofing Underlayment for Ice Dam Protection
- F. ASTM D 4541 Standard Test Method for Pull-Off Strength of Coatings Using Portable Adhesion Testers
- G. ASTM E 96 Standard Test Methods for Water Vapor Transmission of Materials.

1.04 PERFORMANCE REQUIREMENTS

- A. Product provided by this Section shall be a water-based, rubberized asphalt emulsion which rapidly cures in place to provide a seamless waterproofing membrane.
- B. Product shall be solvent free, have VOC content of not more than 30 grams per liter and shall be free of noxious odors.
- C. Product, when applied at minimum 0.060 inch (60 mils) cured thickness, shall meet the following requirements:

REQUIREMENT	RESULT	TEST METHOD
-------------	--------	-------------



Water Vapor Permeance	Not more than 0.1 Perm	ASTM E-96, Method B
Tensile Elongation	Not less than 500 percent	ASTM D-412
Low Temperature Flexibility	No cracking, 180 degree bend over 1-inch mandrel at minus 20 degrees F	ASTM D 1970
Low-Temperature Crack Bridging	Withstand 10 cycles at minus 15 degrees F	ASTM C 836
Peel adhesion on HDPE film, concrete and concrete block	Not less than 10 lb per inch of width OR substrate failure	ASTM D 903
Pull adhesion on concrete and concrete block	Not less than 16 lb per square inch	ASTM D 4541

#### 1.05 SUBMITTALS

- A. Provide submittals in accordance with Section 01 33 00
- B. At bid submission, provide evidence to the Architect of installer qualification by Manufacturer.
- C. Shop drawings showing locations and extent of waterproofing and details of typical conditions.
- D. Manufacturer's technical data sheets and material safety data sheets for Product and Accessories.
- E. Manufacturer's installation instructions.
- F. Manufacturer's documentation of volatile organic compounds (VOC) content for Product and Accessories.
- G. Certification of compatibility by Manufacturer, listing all materials on the Project with which the Product and Accessories may come into contact.
- H. Samples, 3 inch by 4 inch minimum size, of cured Product.

#### 1.06 QUALITY ASSURANCE

- A. Installer shall be experienced in applying the same or similar materials and shall be specifically approved in writing by Manufacturer.
- B. Single-Source Responsibility: Obtain Product and Accessories from single manufacturer.
- C. Product and Accessories shall comply with all state and local regulations controlling use of volatile organic compounds (VOCs).

[Note to Specifier: Retain paragraph D for compliance with requirements of Carlisle's NVELOP™ Plus Warranty.]

- D. Comply with the provisions of the Owner's Building Envelope Commissioning program in accordance with Section 01 91 15.
- E. Pre-Installation/Construction Meetings: Convene [one] [\_\_\_\_\_] week prior to commencing Work of this section, in accordance with Section 01 31 19 - Project Meetings.
- F. Cooperate and coordinate with the Owner's inspection and testing agency. Do not cover any installed Product unless it has been inspected, tested and approved.

#### 1.07 DELIVERY, STORAGE AND HANDLING

- A. Deliver Product and Accessories to Project site in original packages with seals unbroken, labeled with Manufacturer's name, product name, lot number and directions for storage.
- B. Protect Product from freezing.
- C. Store Product and Accessories in their original, undamaged packages in clean, dry, protected location and within temperature range required by Manufacturer.
- D. Avoid spillage. Immediately notify Owner, [Architect] [Consultant] if spillage occurs and start clean up procedures. Clean spills and leave area as it was prior to spill.

#### 1.08 WASTE MANAGEMENT AND DISPOSAL

- A. Separate and recycle waste materials in accordance with Section 01 74 19 – Construction Waste Management and Disposal, and with the Waste Reduction Work Plan.
- B. Place materials defined as hazardous or toxic waste in designated containers.
- C. Ensure emptied containers are stored safely for disposal away from children.

#### 1.09 PROJECT CONDITIONS

- A. Do not apply Product or Accessories during rain or accumulating snowfall.

- B. Apply Product and Accessories within approved ambient and substrate temperature range stated in Manufacturer's literature.
  - C. Do not apply Product or Accessories over incompatible materials.
  - D. Observe safety and environmental measures indicated in Manufacturer's MSDS, and mandated by federal, state and local regulations.
- 1.10 WARRANTIES: Provide the Manufacturer's minimum [five] year material warranty under provisions of Section 01 78 36 – Warranties.

## PART 2 PRODUCTS

- 2.01 PRODUCTS: Provide as manufactured by Carlisle Coatings & Waterproofing, Incorporated. 900 Hensley Lane, Wylie, TX 75098. Phone 1-800-527-7092. Website <http://www.carlisle-ccw.com> :
- A. Spray-Grade: Barricoat™-S pourable consistency, water-based, polymer-modified asphalt
  - B. Roller-Grade: Barricoat™-R paste consistency, water-based, polymer-modified asphalt
- 2.02 ACCESSORIES: Provide as manufactured by Carlisle Coatings & Waterproofing, Incorporated:
- A. Co-Spray: Barricure™ chloride-free liquid concentrate.
  - B. Transition Membrane: 60 mil thickness self-adhering waterproofing membrane strips provided in rolls of various widths. Select either:
    1. MiraDRI 860 Strips
    2. MiraDRI 861 Strips
  - C. Reinforcing Fabric: DCH Reinforcing Fabric woven, white polyester provided in rolls of various widths.
  - D. Contact Adhesive, select any:
    1. CCW-702 OR CCW-702 LV Solvent-Based
    2. CCW-702 WB Water-Based
  - E. Mastic, select either:
    1. LM 800 XL solvent-based synthetic rubber
    2. CCW-704 solvent-based rubberized asphalt
  - F. Fill Compound, select either:
    1. CCW-703 V Trowel-Grade Polyurethane, 2-part
    2. CCW-201 Non-Slump Polyurethane, 2-part

- G. Aerosol Contact Adhesive: CAV-GRIP™
- H. Drainage Composite: MiraDRAIN® as recommended by Manufacturer for the Project.
- I. Perimeter Drainage System: MiraDRAIN - HC®
- J. Protection Board: CCW Protection Board V
- K. Joint Sealant, select either:
  - 1. CCW-201 non-sag, 2-part polyurethane
  - 2. Product by others as approved by Manufacturer. Shall conform to ASTM C 920 Type 1 or 2, Grade NS, Class 25 or 50.
- L. Board Insulation, select either:
  - 1. Insulfoam BG expanded polystyrene, as manufactured by Insulfoam – A Carlisle Company. Available in various thicknesses and compressive strengths.
  - 2. Product by others, as approved by Architect
- M. Insulation Adhesive, select either:
  - 1. CAV-GRIP™
  - 2. Product by others as approved by board insulation and waterproofing membrane manufacturer.

## PART 3 EXECUTION

### 3.01 EXAMINATION

- A. Before any waterproofing work is started, the waterproofing applicator shall thoroughly examine all surfaces for any deficiencies. Should any deficiencies exist, the [Architect] [Owner] [Contractor] shall be notified in writing and corrections made.
- B. Concrete shall be cured for a minimum of three days.
- C. Condition of Concrete Surfaces:
  - 1. The concrete surfaces shall be of sound structural grade, minimum of 2500 PSI compressive strength, and shall have a continuous surface, free of fins, ridges, voids or entrained air holes.
  - 2. Concrete shall be cured by water during method. Curing compounds must be of the pure sodium silicate type and be approved by the Carlisle representative or pass ASTM D 4263.
  - 3. Control joints and/or expansion joints shall have been properly installed at strategic points throughout the field of the deck to control cracking caused by deflection and shrinkage.

4. Voids, rock pockets and excessively rough surfaces shall be repaired with approved non-shrink grout or ground to match the unrepaired areas.
- D. Condition of Concrete Masonry Unit (CMU) Surfaces:
1. Mortar joints shall be struck flush to face of concrete block.
  2. Voids and holes greater than  $\frac{1}{2}$  inch across shall be filled with mortar or non-shrink grout.
  3. Cracks, gaps and joints exceeding  $\frac{1}{4}$  inch width shall be filled with mortar or non-shrink grout.
  4. Surface irregularities exceeding  $\frac{1}{4}$  inch in height or sharp to touch shall be ground smooth or made flush.
  5. If surfaces cannot be made smooth to the satisfaction of the Architect, they shall be covered with a parge coat, typically consisting of one part cement to three parts sand, over area to receive fluid-applied waterproofing.
  6. Mortar droppings shall be removed from surfaces.
- E. Rough gaps around mechanical, electrical and similar penetrations shall be filled with non-shrink grout, mortar, Joint Sealant or Fill Compound and struck flush.
- F. Surfaces shall be sound, dry and free of oil, grease, form release agents, dirt or other contaminants.
- G. Honeycomb in concrete shall be filled with non-shrink grout or Fill Compound

### 3.02 SURFACE PREPARATION

- A. Prepare areas to receive Transition Membrane with Contact Adhesive. Contact Adhesive shall be provided at recommended coverage rate and visible for 1 inch minimum beyond edge of installed Transition Membrane.
- B. Install Transition Membrane according to Manufacturer's instructions in literature.
- C. Encapsulate Reinforcing Fabric as follows: Coat substrate with approximately 30 wet mils of Roller Grade Product, lay fabric into wet surface, coat fabric with approximately 30 more wet mils of Roller Grade Product.
- D. Apply Transition Membrane or Reinforcing Fabric encapsulated in Roller-Grade Product according to Manufacturers instructions and drawings in the following areas:
1. Cold joints

2. Cracks
3. Expansion joints
4. Control joints
5. Inside/outside corners and other change in plane
6. Mechanical/electrical penetrations
7. Transition to different substrate.

### 3.03 INSTALLATION

- A. Allow materials used during surface preparation to cure fully before applying Product.
- B. Spray-Grade Product: Dispense in tandem with Co-Spray according to instructions in Manufacturer's literature.
- C. Roller-Grade Product: Apply according to according to instructions in Manufacturer's literature
- D. Cured membrane thickness shall measure a minimum of 0.060 inch (60 mils).
- E. Provide complete coverage without pinholes or voids. Apply greater thickness of Product as necessary to provide continuous coating over rough surfaces and irregularities.
- F. Allow Product to dry completely before application of Protection Board, Board Insulation or Drainage Composite

### 3.04 SCHEDULE

- A. Seal penetrations made through installed Product according to Manufacturer's instructions and drawings.
- B. Protection Board installed after Product: Attach to surface of Product with Aerosol Contact Adhesive.
- C. Board Insulation installed after Product: Install in accordance with Section 07 21 13 Board Insulation. Attach to surface of Product with Insulation Adhesive.
- D. Drainage Composite installed after Product: Install with fabric side facing soil and connect to Perimeter Drainage System according to Manufacturer's instructions and drawings. Use Aerosol Contact adhesive, to attach Drainage Composite to surface of Product or to surface of board insulation overlying Product.

- E. Backfill to permanently secure Drainage Composite, Board Insulation and Protection Board.
- F. Avoid damaging Product and Accessories during backfill.

3.05 REPAIR AND PROTECTION

- A. Protect from damage during application and remainder of construction period.
- B. Inspect before covering. Repair or replace damaged material according to Manufacturer's instructions and drawings.
- C. Product and Accessories are not designed for permanent exposure. Cover with Drainage Composite, Protection Board or Board Insulation and backfill as soon as schedule allows.
- D. Outdoor exposure of installed Product shall not exceed 30 days.

END OF SECTION